

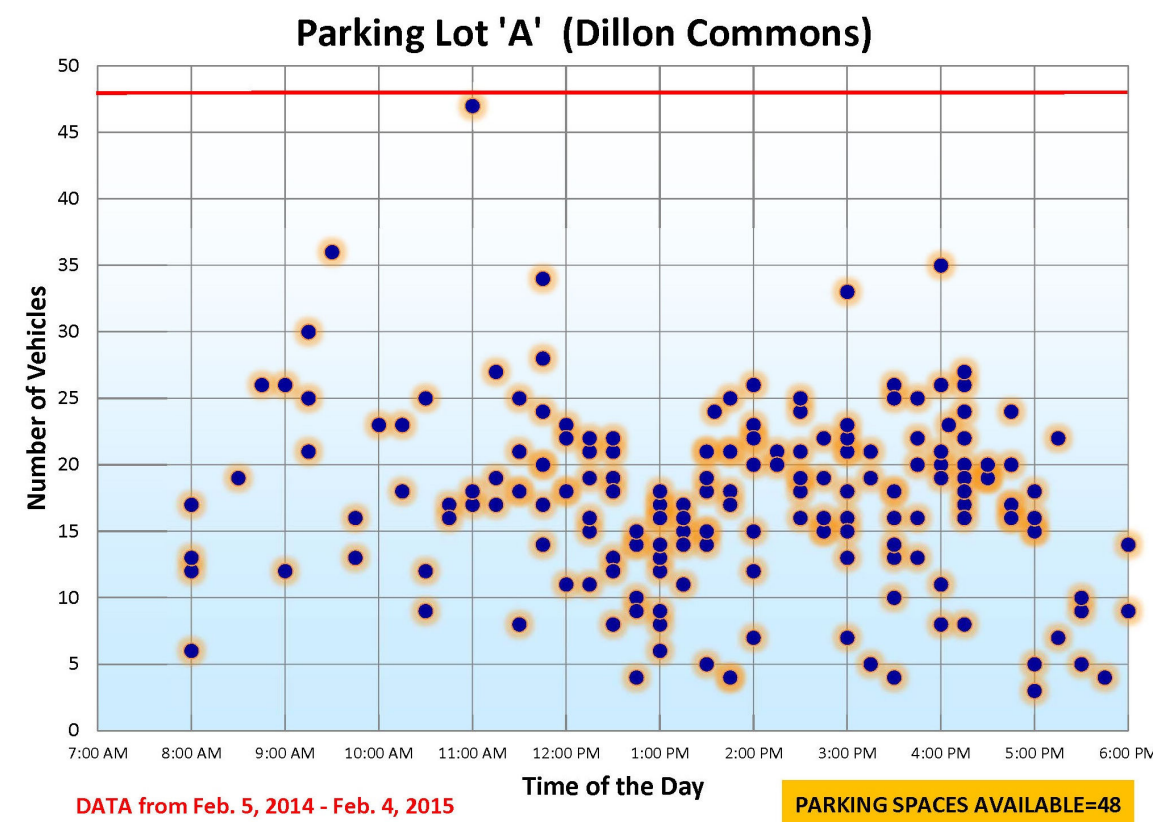

Dillon Town Center Revitalization

Parking Lot 'A'



Parking Study Notes:
 Parking Lot 'A' was shown to be moderately used. It typically only needs about 25-30 spaces. The New Parking Lot will provide 46 SPACES.



Dillon Town Center Location Map

Key Design Concepts

MAINTAIN SIMILAR SIZE	Parking Lot 'A' is reconfigured to provide a main parking area with direct access between Main street & Buffalo. The Parking lot is slightly reduced from 48 spaces to 46 spaces.
IMPROVED TRASH ACCESS	The trash enclosure is relocated to the southwest corner of the parking lot. It is easily accessible to trash trucks coming down the end of the drive.
ADEQUATE ACCESSIBLE PARKING	The proposed design provides accessible parking spaces at each of the existing buildings and future buildings.
PEDESTRIAN CONNECTION TO TOWN PARK	A new strong pedestrian connection is constructed along the east side of the parking lot between Main Street and Buffalo Street.
CREATION OF A FUTURE LOT NW-1	The proposed parking lot layout allows for an additional Lot NW-1 to be constructed between Main Street and the Dillon Commons Building, which would replace the existing building on Lot C-2.

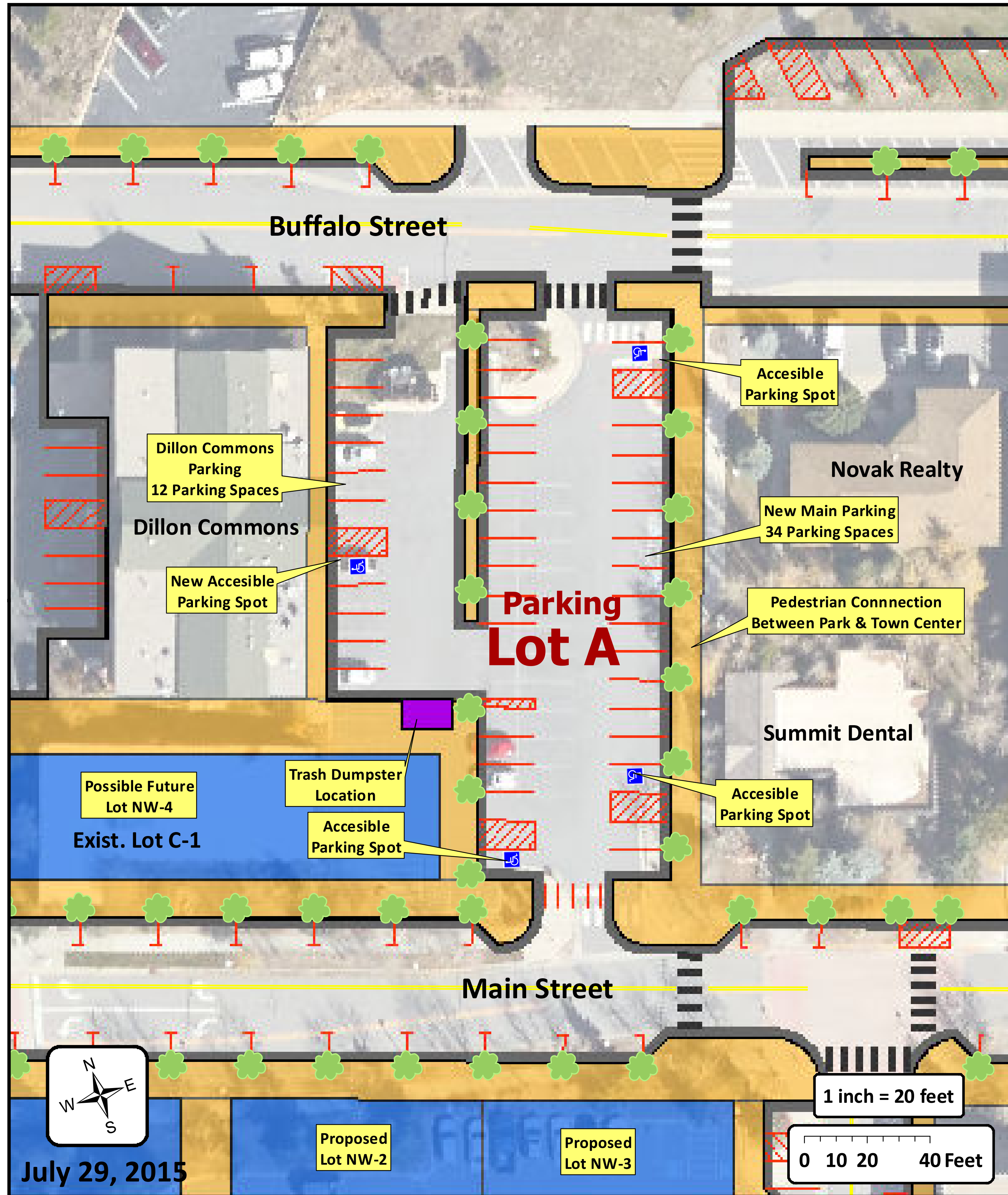

July 29, 2015

1 inch = 20 feet

0 10 20 40 Feet