

### GENERAL NOTES

- DO NOT SCALE DRAWINGS
- REFER TO CODE ANALYSIS REPORT FOR A LISTING OF APPLICABLE BUILDING CODES AND STANDARDS. IT SHALL BE THE RESPONSIBILITY OF THE GENERAL CONTRACTOR AND RESPECTIVE SUBCONTRACTORS TO BUILD TO SATISFY THESE CODES AND CALL FOR ALL NECESSARY INSPECTION.
- REFER TO PROJECT SPECIFICATIONS FOR FURTHER DEFINITION OF THE WORK.
- THE CONTRACTOR SHALL VERIFY ALL EXISTING CONDITIONS AT THE SITE AND REPORT ALL DISCREPANCIES TO THE ARCHITECT BEFORE PROCEEDING WITH THE WORK. CONTACT ARCHITECT FOR CLARIFICATION IN THE EVENT OF ANY DISCREPANCY IN THE CONSTRUCTION DOCUMENTS OR ANY AMBIGUITY OF ARCHITECTURAL INTENT.
- ALL LEGAL EXITS SHALL BE OPERABLE FROM THE INSIDE WITHOUT THE USE OF A KEY OR ANY SPECIAL KNOWLEDGE OR EFFORT.
- ALL PLAN DIMENSIONS ARE TO CENTERLINE OF COLUMN GRID, FACE OF STUD FRAMING, FACE OF CONCRETE, OR FACE OF CMU UNLESS NOTED OTHERWISE.
- THE LARGEST SCALE DRAWING SHALL GOVERN OVER ALL OTHER DRAWINGS.
- "F.V." ON DRAWINGS REFERS TO FIELD VERIFICATION FOR CORRECT DIMENSIONS AND CONDITIONS. NOTIFY ARCHITECT OF ANY DISCREPANCIES. THE GENERAL CONTRACTOR SHALL PREP ALL FLOORS TO RECEIVE FINISHES. COORDINATE DUCT, FLUE, AND VENT PENETRATIONS WITH MECHANICAL CONTRACTOR.
- LOCATE ALL PLUMBING IN PROTECTED AREAS TO AVOID FREEZING OF PIPES AND TRAPS.
- ALL ELEVATIONS SHOWN ON PLANS ARE BUILDING ELEVATIONS (MAIN LEVEL = 100'-0")
- PAINT ALL INTERIOR CONDUIT, DUCTWORK, PIPING, ETC., IN FINISHED SPACES EXPOSED TO PUBLIC VIEW.
- PAINT ALL EXPOSED METAL ON EXTERIOR OF BUILDING WITH HIGH PERFORMANCE PAINT SYSTEM THAT IS NOT INDICATED TO BE PREFINISHED U.N.O., INCLUDING BUT NOT LIMITED TO CONDUIT, PIPING, GAS PIPING, FLASHING, MECH. FLUES AND DUCTS, LINTELS, HOLLOW METAL FRAMING AND DOORS, STEEL, AND MECH. EQUIPMENT.
- PROVIDE TRAPEZE TO SUPPORT SUSPENDED CEILING AS REQUIRED BELOW DUCTWORK OR OTHER OBSTRUCTIONS.
- WALL AND CEILING MATERIALS SHALL NOT EXCEED THE FLAME SPREAD CLASSIFICATIONS LISTED IN THE IBC.
- PROVIDE ACCESS PANELS AT LOCATIONS INDICATED AND AS REQUIRED FOR ACCESS TO EQUIPMENT AND DEVICES INCLUDING, BUT NOT LIMITED TO MECHANICAL, PLUMBING, AND ELECTRICAL WORK.
- PENETRATIONS OF FIRE-RESISTIVE WALLS, FLOOR-CEILING AND ROOF-CEILING SHALL BE PROTECTED AS REQUIRED IN THE IBC.



**SINK COMBS DETHLEFS**  
ARCHITECTURE DESIGN  
475 LINCOLN STREET  
SUITE 100  
DENVER, CO 80203  
Tel: 303-308-0200

**NOT FOR CONSTRUCTION**

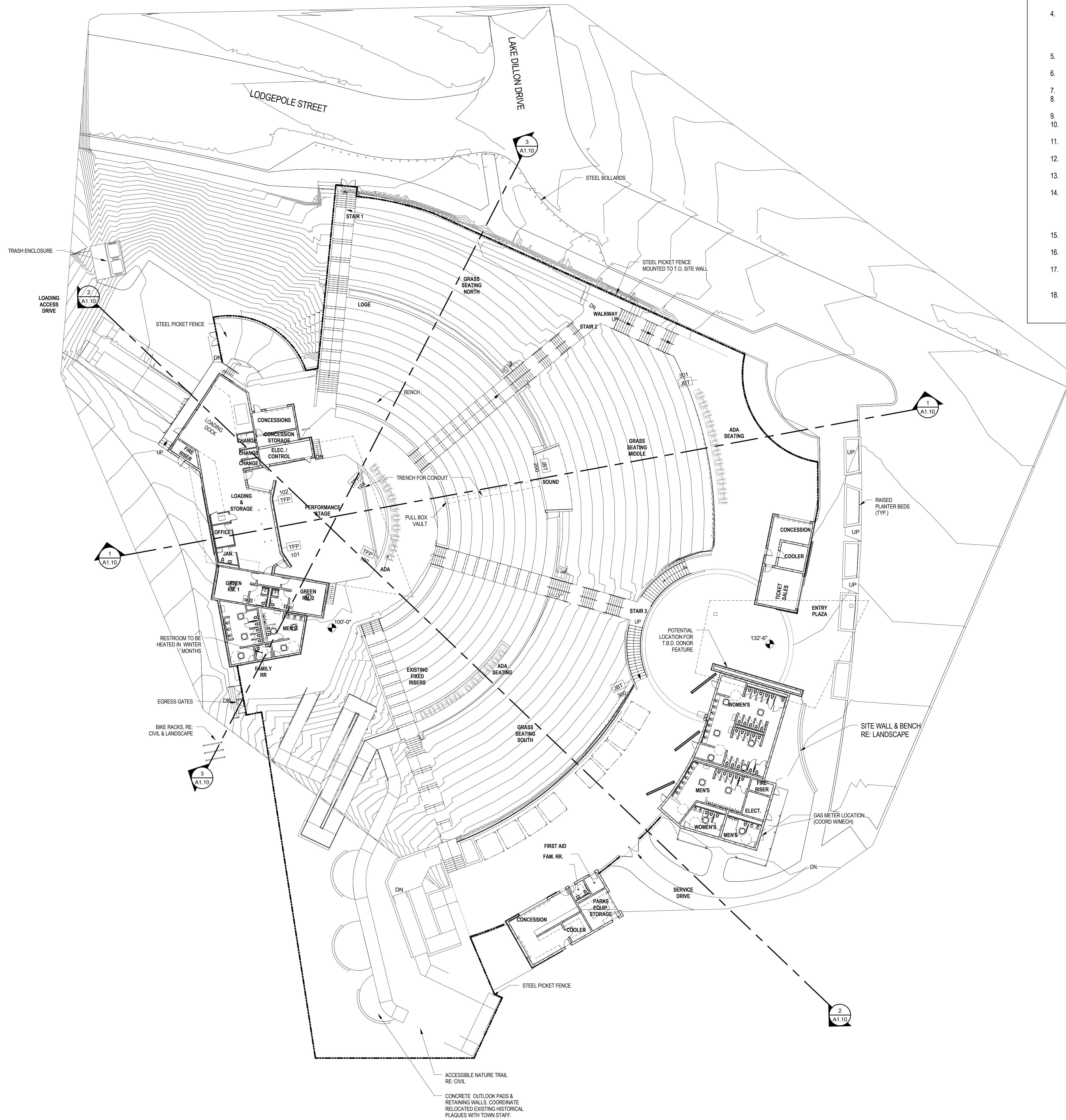

### Dillon Amphitheater Improvements

W. Lodgepole Street  
Dillon, CO

SCD Project No.: 1514

All information appearing herein shall not be duplicated, distributed or otherwise used without the written consent of Sink Combs Dethlefs.

No.	Issues/Revisions:	Date
01	Schematic Design	07/22/16
02	Design Development	10/14/16

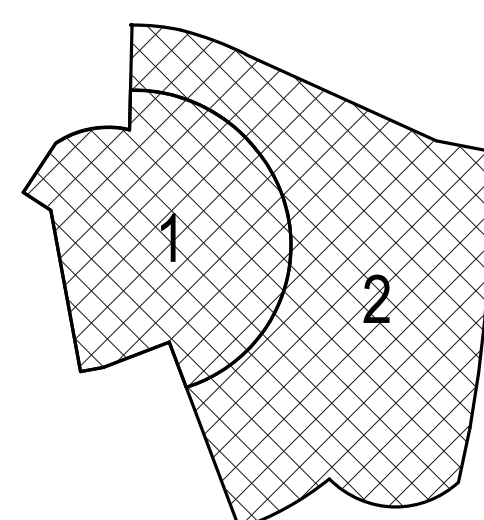

### ARCHITECTURAL SITE PLAN

PLAN NORTH  
1 ARCHITECTURAL SITE PLAN  
1" = 20'-0"